



Tower Hotel

Oklahoma City

Ultimate Meeting Package

*\$65 per person
up to 100 Attendees*

Includes:

Continental Breakfast
Deli Lunch Buffet
Afternoon Snack of Cookies & Brownies
All Day Beverage Station of Iced Tea,
Water, Coffee & Soft Drinks

Meeting Room
Access to Foyer Exhibit Space
Registration Booth
Stage with Podium & Microphone
LCD Projector & Screen
Registration Table
Free Wi-Fi in Meeting Space

*Upgrade to a Hot Lunch Buffet for an
Additional \$7.00 per person.

*Discounted Group Rates with
10 or More Guest Rooms.



For more information please contact the Sales Department:
405-842-6633

Please inquire complete details and terms and conditions for the individual offers prior to booking. This offer may not be combined with other promotions, offers and discounts and is not valid for existing bookings. Other restrictions may apply. Offer is subject to availability and for new bookings only. Guest room rates are valid for single/double occupancy and do not include all taxes, incidental charges, and gratuities. Please inquire policy to address deposits, cancellations and blackout dates that may apply.

1st Floor

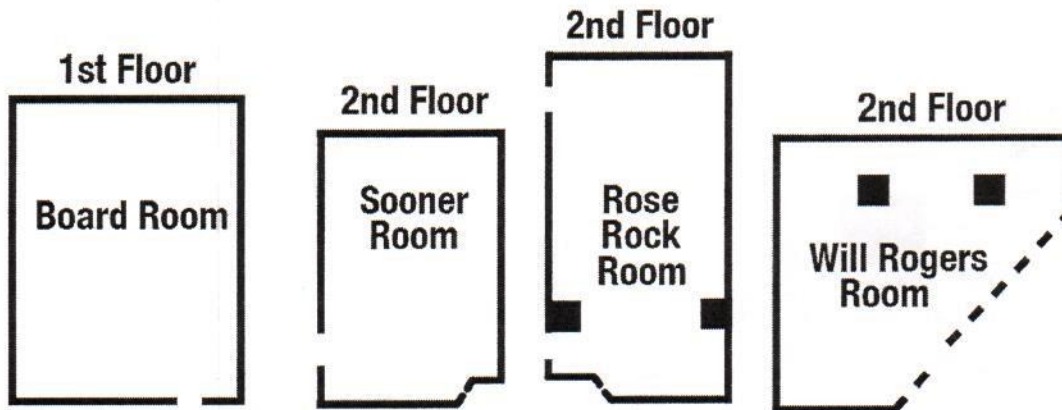
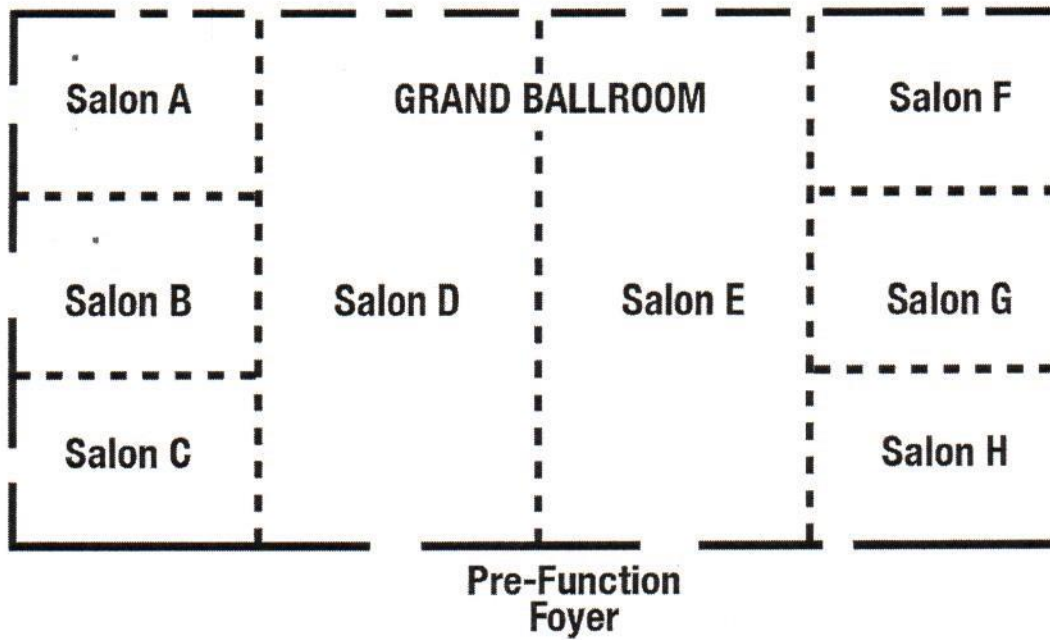

Capacity

Meeting Rooms	Dimensions W x L x H	Square Footage	Capacity				
			Theater	Schoolroom	Conference	Reception	Banquet
Board Room	25'x31'x12'	775	-	-	16	-	-
Grand Ballroom	68'x147'x15'	10,000	1,000	500	-	1,425	800
Salon A	21.6'x31.6'x14'	682	60	32	25	75	40
Salon B	25'x31.6'x14'	790	70	45	32	90	50
Salon C	21.6'x31.6'x14'	682	60	32	25	75	40
Salon D	68'x42'x15'	2,856	350	150	-	450	220
Salon E	68'x42'x15'	2,856	350	150	-	450	220
Salon F	21.6'x31.6'x14'	682	60	32	25	75	40
Salon G	25'x31.6'x14'	790	70	45	32	90	50
Salon H	21.6'x31.6'x14'	682	60	32	25	75	40
Sooner Room	24'x27'x10'	634	25	30	28	50	40
Rose Rock Room	24'x42'x10'	987	50	40	28	100	50
Will Rogers Room	20'x28'x10'	560	45	20	16	40	30